



The Choice of the Professional



The Choice of the Professional

Building Adhesives Limited,

Longton Road, Trentham, Stoke-on-Trent, ST4 8JB, England.

Sales Tel: +44 (0) 1782 591160 Fax: +44 (0) 1782 591131

Technical Tel: +44 (0) 1782 591120 Fax: +44 (0) 1782 591121

Website: www.building-adhesives.com

Unit 6, Plato Business Park, Damastown Industrial Estate,
Damastown, Dublin 15, Ireland.

Tel: +353 (0) 1 822 2776 Fax: +353 (0) 1 822 2777



PROFESSIONAL FIXING GUIDE

Note: The customer must verify the suitability of any information, opinion, recommendation or advice ("Information") provided by the Company for the particular application for which any goods are intended to be used and the Company accepts no liability (whether in contract, tort or otherwise) whatsoever for any loss, damage or expense arising from the misuse of any Information it supplies nor for the use of any Information in or for applications which are unsuitable or inappropriate. Building Adhesives Limited operates a continuous research and development programme and reserves the right to alter or to update Information from time to time.

*Microban and the Microban symbol are trademarks of the Microban Products Company, Huntersville, NC

© Copyright Building Adhesives Limited 2004



Powerspec	2
Technical support & training	3
Wall & floor trowels	5
European standards	7
Movement joints	8
General preparation	9
Background preparation - walls	10
Base preparation - floors	14
WP1 tanking system	19
Adhesive coverage	21
Grout coverage	23
Wall tiling selector	25
Floor tiling selector	27
Tile calculator	29
Flexibility chart	30
Product summary	31
Colour charts	41

The **NEW** & easier way of choosing tile adhesives & grouts

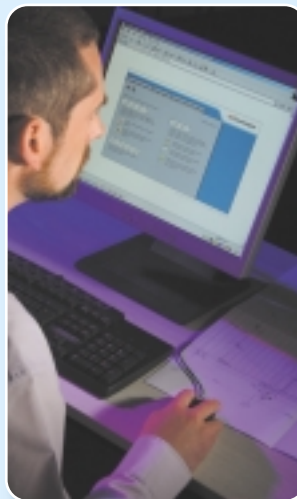

- Specially designed for Architects, Specifiers, Distributors, Contractors & Tile Fixers
- Instant NBS M40 format specifications
- The latest technical, safety & product data
- Fast accurate information at your fingertips always available, always online at **www.powerspeconline.com**
- Also available as a CD-Rom



40 years' experience in the development and manufacture of a comprehensive range of ceramic tile adhesives, grouts and ancillary products, has guaranteed BAL's position as the chosen brand for professional tile fixers, contractors, architects and specifiers.

BAL products are guaranteed to perform and may be specified with confidence. BAL operates a quality management system and is accredited to BS EN ISO 9001 and its products are covered by the BAL 10 year guarantee.

BAL WEBSITE

The BAL website offers specifiers, contractors, distributors and fixers information on BAL products and services. Visit the website on www.building-adhesives.com for up to date information.

- Distributor locator search
- On-line literature including range brochure, fixing guide, material safety/technical data
- Case studies, FAQs & latest news
- Up-to-date training course programmes
- On-line technical advice

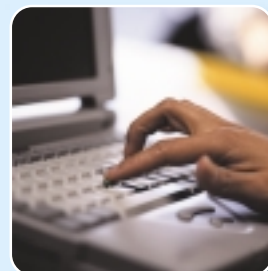

www.building-adhesives.com



TECHNICAL SUPPORT

BAL's commitment to quality extends beyond the product. BAL's Technical Advisory Service handles over 30,000 enquiries each year, offering free help, advice and specifications on all aspects of ceramic tiling installations. A nationwide team of BAL Product Support Technicians are on hand to offer practical knowledge and on-site training.

0 8 4 5
6 0 0 1 2 2 2



- Over 30,000 telephone enquires per year
- Free advice on all aspects of ceramic tiling
- Free tiling specifications
- Field investigation reports
- Calls to the professional helpline above are charged at local rate



TRAINING

BAL recognises the importance of training and remains committed to investing in national and regional training.

New NVQ Programme - Level 2 in Wall & Floor Tiling

- On-site assessment
- Qualified, expert trainers
- Nationally recognised qualification
- A step towards CSCS

Practical and Specialist Tile Fixing Courses

- Beginner to advanced
- Hands-on experience
- Technical lectures
- Latest products
- Latest tiling techniques
- CITB grant approved

For further information on course dates and bookings call 01782 591123.



BAL TROWELS

WALL TROWELS

Using the right trowel for the job is very important and can often be crucial to the success of the installation.

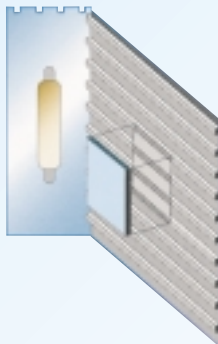

BAL SQUARE NOTCHED TROWEL

- 6mm square notches at 25mm centres.
- Suitable for thin-bed fixing in interior dry areas for most ceramic, marble and natural stone wall tiles.
- Coverage: approx. 50%.

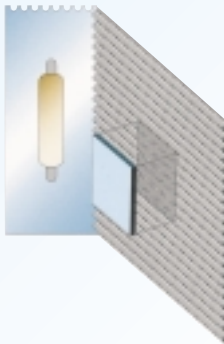

BAL ROUND NOTCHED TROWEL

- 6mm round notches at 12mm centres.
- Suitable for thin-bed fixing in interior dry areas for most ceramic, marble and natural stone wall tiles.
- Coverage: approx. 70%.

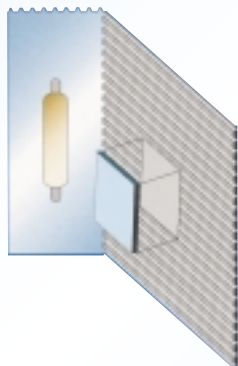

BAL THIN BED SOLID BED TROWEL

- 10mm wide notches at top, tapering to 5mm deep at 12.5mm centres.
- For solid bed fixing of most ceramic, marble and natural stone tiles on flat wall surfaces.
- Ideal for use in interior wet areas and hygiene critical areas.
- Coverage: 100% achievable at 2-3mm bed depth.

BAL TROWELS

WALL/FLOOR TROWELS

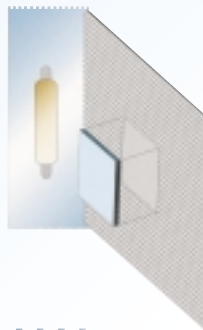

BAL MOSAIC TROWEL

- 4mm square notches at 8mm centres.
- Suitable for thin-bed fixing mosaics/tiles up to 100mmx100mm.
- Coverage: approx. 90%.

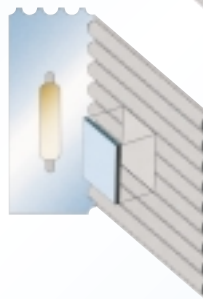

BAL THICK BED SOLID BED TROWEL

- 20mm wide round notches with 10mm depth at 28mm centres.
- Suitable for all floors and wall backgrounds or tiles with recessed or keyed back patterns.
- Coverage 100% achievable at 3-4mm bed depth

FLOOR TROWELS

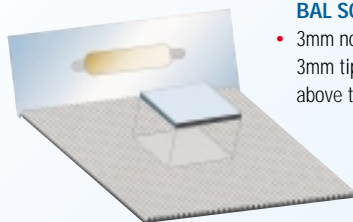

BAL SOLID BED TIPPED TROWEL

- 3mm notches at 6mm centres with 3mm tips at each end and protruding above the notches.
- Designed for use with BAL two-part adhesive systems.
- The tips ensure a 4mm solid bed.

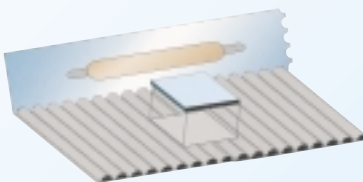

BAL LARGE FORMAT TROWEL

- 20mm wide round notches 13mm deep at 28mm centres.
- Ideal for fixing tiles over 300mmx300mm.

EN 12004

SYMBOL		DESCRIPTION
TYPE	CLASS	
C	1	Normal cementitious adhesive
C	1 F	Fast-setting cementitious adhesive
C	1 T	Normal cementitious adhesive with reduced slip
C	1 F T	Fast-setting cementitious adhesive with reduced slip
C	2	Improved cementitious adhesive with additional characteristics
C	2 E	Cementitious adhesive with extended open time
C	2 F	Improved fast-setting cementitious adhesive with additional characteristics
C	2 T	Improved cementitious adhesive with additional characteristics and reduced slip
C	2 T E	Improved cementitious adhesive with additional characteristics, reduced slip and extended open time
C	2 F T	Improved fast-setting cementitious adhesive with additional characteristics and reduced slip
D	1	Normal dispersion adhesive
D	1 T	Normal dispersion adhesive with reduced slip
D	2	Improved dispersion adhesive with additional characteristics
D	2 T	Improved dispersion adhesive with additional characteristics and reduced slip
D	2 T E	Improved dispersion adhesive with additional characteristics, reduced slip and extended open time
R	1	Normal reaction resin adhesive
R	1 T	Normal reaction resin adhesive with reduced slip
R	2	Improved reaction resin adhesive with additional characteristics
R	2 T	Improved reaction resin adhesive with additional characteristics and reduced slip

EN 13888

SYMBOL		DESCRIPTION
TYPE	CLASS	
C	G1	Normal cementitious grout
C	G2	Improved cementitious grout with additional characteristics
R	G1	Reaction resin grout

EN 12002

SYMBOL		DESCRIPTION
TYPE	CLASS	
C	S1	Deformable adhesive
C	S2	Highly deformable adhesive

MOVEMENT JOINTS

Movement joints are an essential part of tiling. Incorrectly incorporated joints will often lead to installation failures.

Movement joints should be a minimum 6mm width and incorporated:

FOR INTERIOR WALL TILING

- Over existing and/or structural movement joints.
- Where tiling abuts other materials.
- Where tiling is continued across junctions of different background materials.
- In large tiled areas, at internal corners and at 3-4.5m centres horizontally and vertically.
- Where stresses are likely to be concentrated, i.e. at changes of alignment.

FOR EXTERIOR WALL TILING

Incorporate joints as per interior wall tiling above and in addition:

- At storey heights horizontally and 3-4.5m apart vertically.
- At external angles, vertically 0.25m-1m from the angle and symmetrically where possible.
- Where an intermediate substrate is used, the movement joints should extend through it.

FOR INTERIOR/EXTERIOR FLOOR TILING

- Over existing and/or structural movement joints.
- Around the perimeter of the floor, in door openings and where tiling abuts columns, curbs, steps and permanent fixtures.
- Where tiling is across junctions of different base materials.
- In large floor areas, tiling should be divided into bays at 8-10m intervals. On suspended floors the bay size should be reduced and additional joints provided over supporting walls or beams.

GENERAL PREPARATION

GENERAL PREPARATION

Before commencing any work ensure that the background/base is:

- Sufficiently flat.
- Free from any contamination.
- Clean.
- Dry.
- Suitable for the intended service conditions.
- Sufficiently strong and rigid to support the tile finish.

Notes to be used in conjunction with background preparation 1, 2, 3 & 4 and base preparation 5, 6, 7 & 8 instructions:

In wet areas, tank out with BAL WP1 SHOWER KIT/WP1 TANKING SYSTEM. In intermittently wet areas, e.g. domestic showers, an epoxy grout such as BAL MICROPOXY may be used to offer additional protection. Fill movement joints with BAL MICROSEAL SILICONE SEALANT.

To prevent any pooling of water, BAL ACRYBASE can be used to create falls/level out the floor prior to tanking for base 5, and BAL FASTFLEX for bases 6, 7 and 8.

CODES OF PRACTICE

The information/advice given in this guide is based on the British Standard BS 5385 parts 1 to 5 - the code of practice for wall and floor tiling.

- Part 1:1995. Code of practice for the design and installation of internal ceramic and natural stone wall tiling and mosaics in normal conditions.
- Part 2:1991. Code of practice for the design and installation of external ceramic wall tiling and mosaics (including terracotta and faience tiles).
- Part 3:1989. Code of practice for the design and installation of ceramic floor tiles and mosaics.
- Part 4:1992. Code of practice for tiling and mosaics in specific conditions.
- Part 5:1994. Code of practice for the design and installation of terrazzo tile and slab, natural stone and composition block floorings.

Other relevant standards include:

- BS 8000:Workmanship on building sites. In particular:
Part 2:1990 - Code of practice for concrete work.
Part 3:2001 - Code of practice for masonry.
Part 8:1994 - Code of practice for plasterboard partitions and dry lining.
Part 9:1999 - Code of practice for cement:sand floor screeds and concrete floor toppings.
Part 10:1995 - Code of practice for plastering and rendering.
Part 11:1989 - Code of practice for wall and floor tiling.
- BS 8203:2001:Installation of resilient floor coverings.
- BS 8204:1999:Parts 1 and 2. In situ floorings.

BACKGROUND PREPARATION - WALLS

GYPSUM PLASTER¹

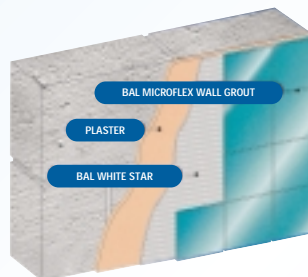

- The weight of tiling should not exceed 20kg/m².

- Allow new plaster a minimum 4 weeks drying time.
- The finish coat must be free from contaminants.
- Any defective areas should be made good.
- Plaster with a polished surface should be brushed with a stiff bristle brush and primed with a mixture of 1:4 BAL BOND SBR: water or 1:1 BAL PRIME APD: water. Allow primer to dry.

¹See additional notes in general preparation, page 9.

GYPSUM PLASTERBOARD²

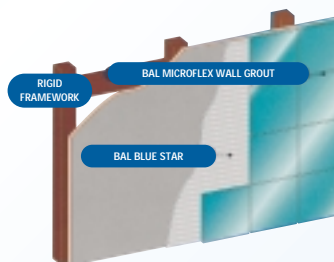

- Boards must be dry, securely fixed and rigid with no protruding fixings.
- The weight of tiling should not exceed 32kg/m².

²See additional notes in general preparation, page 9.

CEMENT:SAND RENDERING

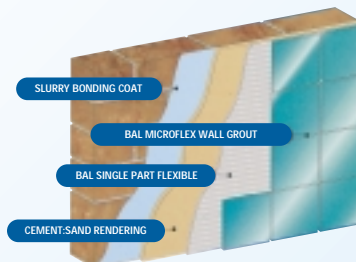

- Allow new rendering a minimum 2 weeks drying time (3 weeks for swimming pools), and 24 hours for render containing BAL QUICKSET CEMENT.

BACKGROUND PREPARATION - WALLS

LIGHTWEIGHT BLOCK WALLING

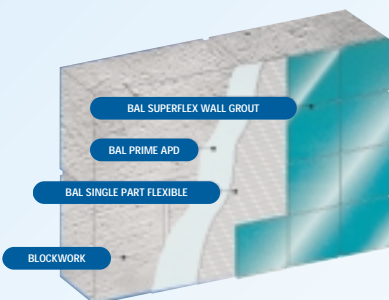

- Allow a minimum 6 weeks drying time before rendering/plastering.
- Direct fixing is only acceptable when the wall is smooth-faced.
- Without rendering, it is only suitable for internal dry conditions.

DENSE CONCRETE/BLOCK WALLING

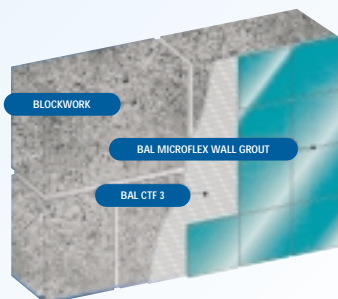

- Allow a minimum 6 weeks drying time before rendering/plastering.
- Direct fixing is only acceptable when the wall is smooth-faced.

GLAZED TILES/BRICKS

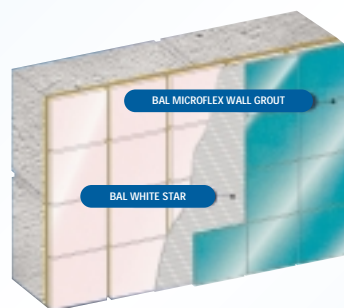

- Existing tiles/bricks must be securely bonded to their bed and must be in sound, clean condition.
- Any loose tiles should be removed and made good with 1:3 cement:sand mortar, applied over a slurry bonding coat (2:1 cement:BAL BOND SBR).

BACKGROUND PREPARATION - WALLS

FIBRE REINFORCED CEMENT SHEETS³

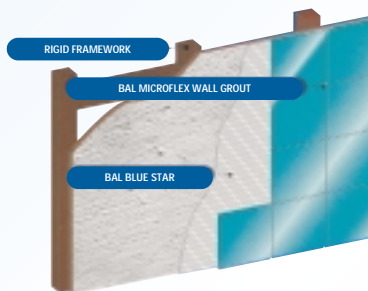

³See additional notes in general preparation, page 9.

- Sheets must be dry, securely fixed and rigid - screwed to a seasoned timber or other suitable proprietary framework at 300mm centres.
- Use moisture resistant boards.
- Seal the reverse side and edges with BAL BOND SBR.
- Do not seal or prime surfaces to be tiled.

FIBRE MESH REINFORCED CEMENT FACED TILE BACKER BOARDS ONTO RIGID FRAMEWORK

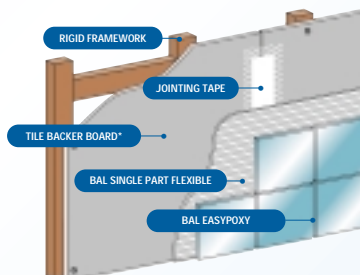

- Boards must be dry, securely fixed and rigid without protruding fixings.
- Do not seal or prime surfaces to be tiled.
- Use the appropriate tape over joints.

*Check the suitability of tile backer boards with the manufacturer.

FIBRE MESH REINFORCED CEMENT FACED TILE BACKER BOARDS ONTO CONCRETE, BLOCKWORK, BRICK & RENDER

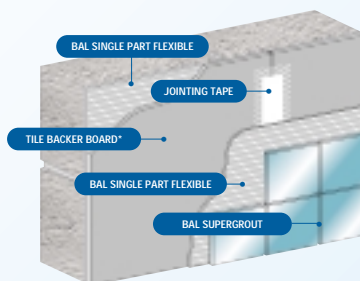

- Boards must be dry, securely fixed and rigid without protruding fixings.
- Do not seal or prime surfaces to be tiled.
- Use the appropriate tape over joints.

*Check the suitability of tile backer boards with the manufacturer.

BACKGROUND PREPARATION - WALLS

PLYWOOD/CHIPBOARD/CALCIUM SILICATE BOARDS¹

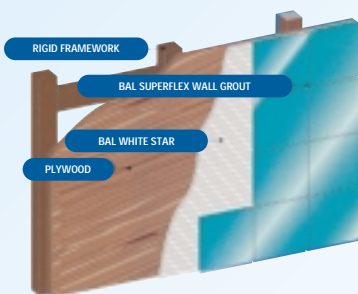

- Sheets must be dry, securely fixed and rigid - screwed to a seasoned timber or other suitable proprietary framework at 300mm centres.
- Use moisture resistant or exterior grade boards.
- Seal the reverse side and edges with BAL BOND SBR.
- Do not seal or prime surfaces to be tiled.

¹See additional notes in general preparation, page 9.

PAINTED WALLS

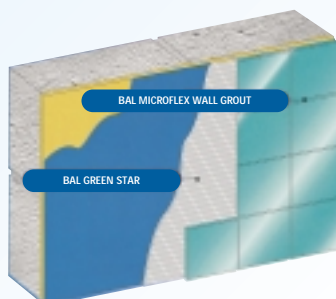

- Ensure that the paint is in a sound condition.
- Check by applying some carpet tape to clean, dry paint surfaces. Leave for 10 minutes before tearing off.
- If paint is removed with the tape, remove all areas of unsound paint by mechanical means.
- Do not use paint strippers.

TECHNICAL HELPLINE



BASE PREPARATION - FLOORS

CEMENT:SAND SCREEDS



For new screeds:

- Allow a minimum 3 weeks drying time, or 24 hours for BAL QUICKSET CEMENT.

For existing screeds:

- Cut out all loose or hollow portions and make good with a 1:3 cement:sand mortar applied over a slurry bonding coat*. Alternatively make good with a mixture of 2:1 BAL POURABLE THICK BED/BAL PTB FLEXIBLE:BAL BOND SBR over a slurry bonding coat*.
- Remove any unsound adhesive residues without damaging the base.

*Slurry bonding coat:

- By weight 2:1 BAL QUICKSET CEMENT: BAL BOND SBR, pre-diluted 1:1 with clean water.
- Or 2:1 Portland cement: BAL BOND SBR by weight.

CONCRETE BASES

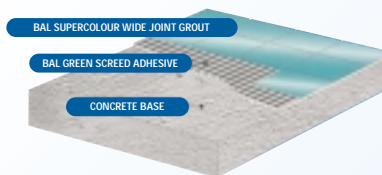

- Allow a minimum 6 weeks drying time or 1 week when BAL GREEN SCREED ADHESIVE is used.

ASPHALT BASES

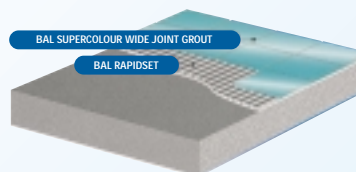

- The mastic asphalt should be sound, with a natural float finish and laid on a firm rigid base.
- The asphalt should be a suitable grade e.g. flooring.
- The surface should be sufficiently regular to suit bedding depths of adhesive.
- Remove any surface contaminants.

BASE PREPARATION - FLOORS

ANHYDRITE SCREEDS⁵

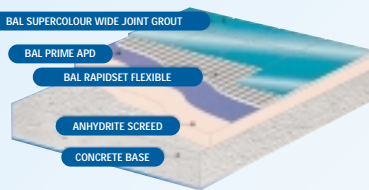

- Allow screeds to dry out in accordance with the manufacturer's instructions.
- Mechanically abrade the top surface to remove the weak layer.
- In internal dry areas, remove all dust and prime with two coats of neat BAL PRIME APD.
- In wet areas, tank with BAL WP1 TANKING SYSTEM.

⁵See additional notes in general preparation, page 9.

PLYWOOD OVERLAID TONGUE & GROOVE FLOORBOARDS⁶

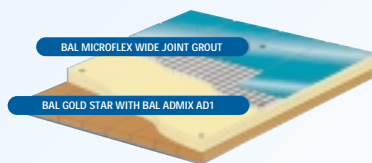

- Existing floorboards must be dry, securely screw fixed and acceptably level.

⁶See additional notes in general preparation, page 9.

FLOATING CHIPBOARD/PLYWOOD FLOORS⁷

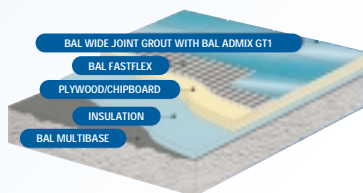

- The concrete base should be flat. Level the floor using BAL MULTIBASE/ BAL ACRYBASE if necessary.
- The insulation layer must be sufficiently strong to support the tiling load.
- The timber sheets are of a water resistant or exterior grade. They must be dry and rigid without protruding

⁷See additional notes in general preparation, page 9.

- fixings. Seal the reverse side and edges with BAL BOND SBR. Do not prime or seal surfaces to be tiled.
- The sheets should have tongue & groove edges and be glued and well bonded. Avoid too many joints.
- Leave at least a 15mm gap between board edges and walls/any interruptions in the floor. Fill the gap with an insulation strip.
- The floor should be stable and able to carry the expected trafficking and additional load without excessive movement or deflection.

BASE PREPARATION - FLOORS

TONGUE & GROOVE FLOORBOARDS⁸

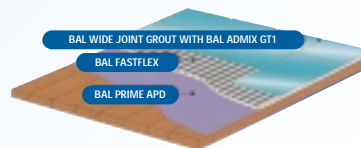

- The boards must be dry, free from varnish, securely fixed and rigid without protruding fixings.
- Boards must be screwed down to the supporting joists at 300mm centres.
- Seal board surface with two coats of BAL PRIME APD.
- Apply a second coat at 90° to the first.
- Allow each coat to dry.

⁸See additional notes in general preparation, page 9.

CERAMIC/QUARRY TILE/TERRAZZO/NATURAL STONE BASES

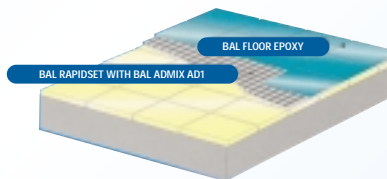

- Existing tiles must be firmly bonded to their base and must be in sound, clean condition.
- Any loose tiles should be removed and made good with a 1:3 cement:sand mortar applied over a slurry bonding coat (1:2 cement: BAL BOND SBR). Alternatively make good with BAL POURABLE THICK BED/ BAL PTB FLEXIBLE over a slurry bonding coat of 2:1 the adhesive: BAL BOND SBR.

VINYL TILE/SHEET BASES

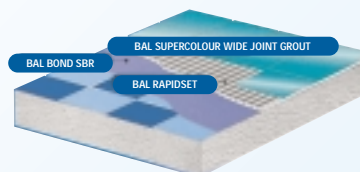

- Existing vinyl tiles/sheets should be firmly bonded to their base and must be in sound, clean condition.

- Any loose tiles should be removed and made good with a levelling compound, e.g. BAL ACRYBASE, dependent on underlying substrate.
- Remove all traces of grease/polish.
- If not tiling with a BAL Porcelbond Plus product, prime with BAL Bond SBR and allow to dry. Fix tiles within 24 hours of priming.

BASE PREPARATION - FLOORS

TILING TO HEATED SCREEDS

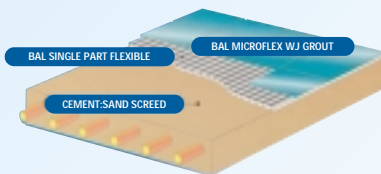

- Allow a minimum 3 weeks drying time for Portland cement, and 1 week for BAL QUICKSET CEMENT.

- The screed should be heated at maximum 5°C per day to 25°C and maintained for 3 days before cooling down to room temperature.
- The heating system should be turned off 24 hours before tiling, or turned down to below 15°C in cold weather.
- The floor can be grouted 8 days after tiling and after a further 6 days can be heated up to the operating temperature at maximum 5°C per day.

TILING TO UNDER TILE HEATING SYSTEM ONTO CEMENT:SAND SCREDS

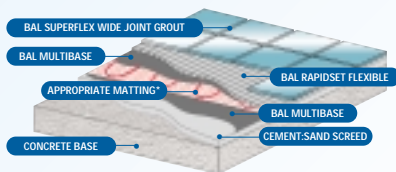

- The base must be sufficiently flat to permit the flatness of finished tiling.
- The base must be suitable for the intended service conditions.

*Check the suitability of matting with the manufacturer.

- The base must be sufficiently strong and rigid to support the tile finish, and free from contamination.
- Allow a minimum 6 week drying time for new concrete and 3 weeks for new cement:sand screeds.
- Prime highly absorbent cement:sand screeds with two coats of BAL PRIME APD diluted 1:1 with water.
- Level floors with BAL MULTIBASE/BAL ACRYBASE where necessary.

TILING TO UNDER TILE HEATING SYSTEM ONTO TIMBER FLOORS

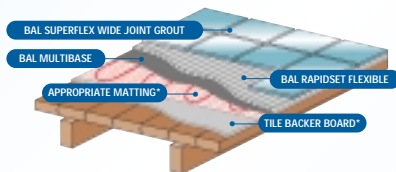

- The new timber base should have noggings between the joists at 300mm centres.

*Check the suitability of the matting and the tile backer board with the manufacturers.

- The floor boards should be overlaid with tile backer board (minimum thickness 10mm), or plywood (minimum thickness 15mm) screwed to both noggings and joists at 300mm centres.
- When using plywood, prime with one coat of BAL BOND SBR and allow to dry.

BASE PREPARATION - FLOORS

TILING TO IMPACT SOUND DEADENING INSULATION

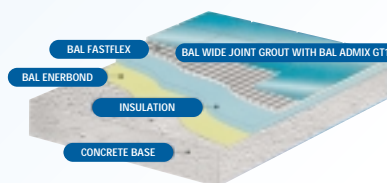

- The insulation must be laid on a flat, rigid base without any protrusions.
- Spread BAL ENERBOND over the base and allow to become tacky (30-60 mins).
- Press the insulation into the adhesive.

GLASS REINFORCED POLYESTER (GRP) BACKGROUNDS/BASES

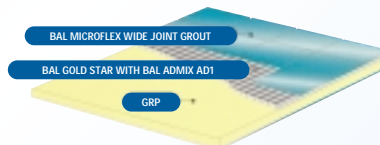

- Check that the GRP is a suitable grade for the intended application with the manufacturer.
- Surface must be free from contaminants. Excess surface wax should be removed.
- The GRP coating must be sound. Any exposed fibres must be sealed.
- Wash down with clean water and allow to dry.

STEEL BACKGROUNDS/BASES

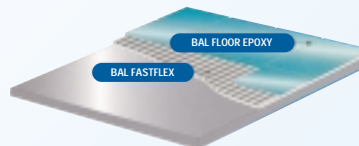

- The surface should be firm, rigid and free from deflection/contaminants.

BAL WP1 WATERPROOFING SYSTEM

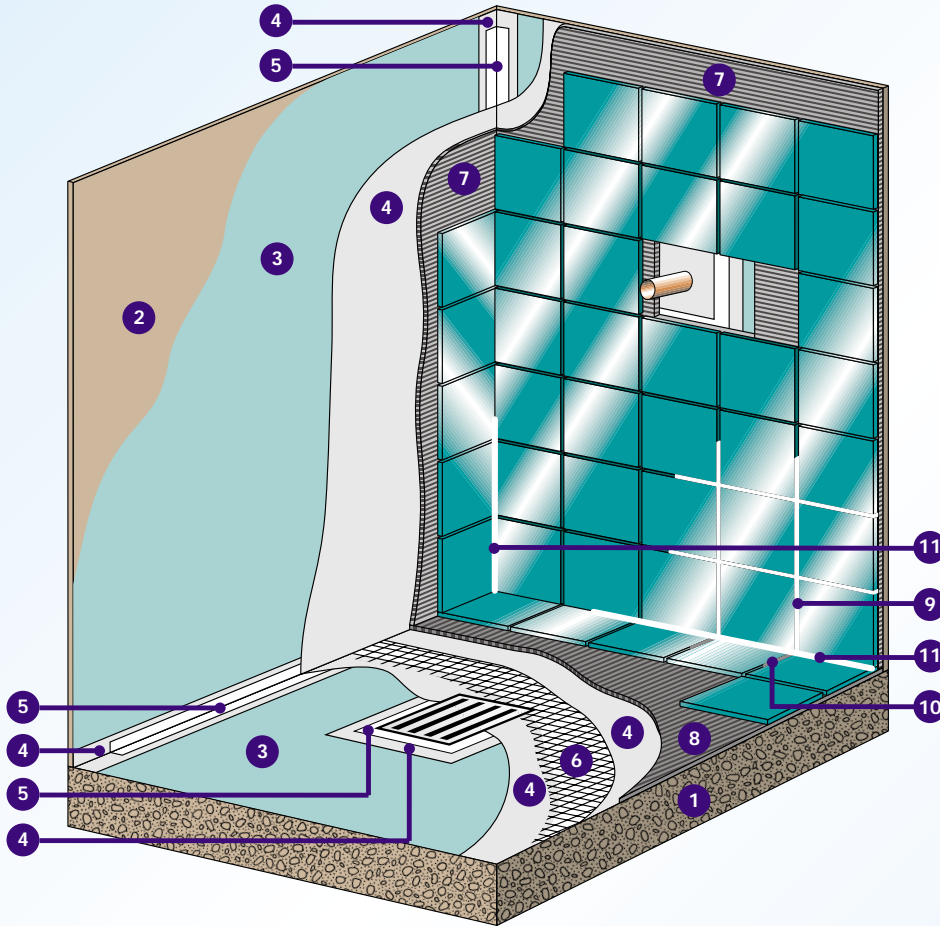

- 1 Concrete Base
- 2 Plasterboard
- 3 BAL Prime APD
- 4 BAL WP1 Waterproof Coating
- 5 BAL WP1 Polyester Tape
- 6 BAL WP1 Polyester Matting
- 7 BAL White Star
- 8 BAL Single Part Flexible
- 9 BAL Microflex Wall Grout
- 10 BAL Microflex Wide Joint Grout
- 11 BAL Microseal Silicone Sealant

- Prime all surfaces with BAL PRIME APD and allow to dry.
- At the following locations apply BAL WP1 COATING reinforced with BAL WP1 POLYESTER TAPE:
 - Internal and external corners of walls/partitions and their junctions with bases, upstands and columns, etc.
 - Pipe penetrations, drainage channels and outlets.
 - Junctions of different background/base materials.
 - Cracks and joints in background/base.

- Apply a second coat of BAL WP1 COATING over BAL WP1 POLYESTER TAPE.
- Apply BAL WP1 COATING to walls.
- Apply BAL WP1 COATING to floors.
- For wet areas, e.g. showers, and where some vibration or deflection may be expected, e.g. timber bases, reinforce with BAL WP1 POLYESTER MATTING. Bed the matting into the coating and apply a second layer of coating over the top.
- Ensure that BAL WP1 TANKING SYSTEM is applied free from voids.
- Allow membrane to dry for at least 24 hours before tiling.

ADHESIVE COVERAGE

ADHESIVE COVERAGE

PRODUCT	SIZE	DRY AREA (WALL) BAL Mosaic Trowel	DRY AREA (WALL) BAL Round Notched Trowel	WET AREA (WALL) BAL Thin Bed Solid Bed Trowel	FLOOR BAL Thick Bed Solid Bed Trowel	FLOOR BAL Large Format Trowel	FLOOR BAL Solid Bed Tipped trowel
BAL READY MIXED ADHESIVES							
BAL GREEN STAR	15 kg	-	10.7m ²	5.2m ²	-	-	-
	7.5 kg	-	5.4m ²	2.6m ²	-	-	-
	3.75 kg	-	2.7m ²	1.3m ²	-	-	-
BAL BLUE STAR	15 kg	-	8.3m ²	4.5m ²	-	-	-
	7.5 kg	-	4.2m ²	2.3m ²	-	-	-
	3.75 kg	-	2.1m ²	1.1m ²	-	-	-
BAL WHITE STAR	15 kg	-	0.8m ²	0.5m ²	-	-	-
	7.5 kg	-	10.0m ²	4.7m ²	-	-	-
	3.75 kg	-	5.0m ²	2.3m ²	-	-	-
BAL GRIP	15 kg	-	2.5m ²	1.2m ²	-	-	-
	7.5 kg	-	1.0m ²	0.5m ²	-	-	-
	3.75 kg	-	8.3m ²	4.5m ²	-	-	-
BAL TILE & GROUT	15 kg	-	4.2m ²	2.3m ²	-	-	-
	7.5 kg	-	7.5m ²	3.8m ²	-	-	-
	3.75 kg	-	3.8m ²	1.9m ²	-	-	-
	15 kg	-	1.9m ²	1.0m ²	-	-	-
	7.5 kg	-	0.8m ²	0.4m ²	-	-	-
	3.75 kg	-			-	-	-
BAL CEMENTITIOUS ADHESIVES							
BAL GOLD STAR	20 kg	-	10.0m ²	6.9m ²	5.0m ²	-	-
	10 kg	-	5.0m ²	3.4m ²	2.5m ²	-	-
	5 kg	-	2.5m ²	1.7m ²	1.3m ²	-	-
BAL CTF3	20 kg	-	10.0m ²	6.9m ²	5.0m ²	-	-
	10 kg	-	5.0m ²	3.4m ²	2.5m ²	-	-
	5 kg	-	2.5m ²	1.7m ²	1.3m ²	-	-
BAL RAPIDSET	20 kg	-	10.0m ²	6.9m ²	5.0m ²	-	-
	10 kg	-	5.0m ²	3.4m ²	2.5m ²	-	-
	5 kg	-	2.5m ²	1.7m ²	1.3m ²	-	-
BAL POURABLE THICK BED	20 kg	-	-	-	3.4m ²	2.3m ²	-
BAL FLEXIBLE CEMENTITIOUS ADHESIVES							
BAL MOSAIC-FIX	20 kg	12.5m ²	10.0m ²	8.0m ²	-	-	-
	10 kg	6.3m ²	5.0m ²	4.0m ²	-	-	-
	5 kg	3.1m ²	2.5m ²	2.0m ²	-	-	-
BAL GREEN SCREED ADHESIVE	20 kg	-	-	-	5.3m ²	-	-
BAL SINGLE PART FLEXIBLE	20 kg	-	10.0m ²	8.0m ²	5.3m ²	-	-
	10 kg	-	5.0m ²	4.0m ²	2.7m ²	-	-
	5 kg	-	2.5m ²	2.0m ²	1.3m ²	-	-
BAL RAPIDSET FLEXIBLE	20 kg	-	10.0m ²	8.0m ²	5.3m ²	-	-
	10 kg	-	5.0m ²	4.0m ²	2.7m ²	-	-
	5 kg	-	2.5m ²	2.0m ²	1.3m ²	-	-
BAL PTB FLEXIBLE	20 kg	-	-	-	3.8m ²	2.4m ²	-
BAL TWO PART ADHESIVES							
BAL FLEX	7kg & 5L	-	6.1m ²	4.7m ²	2.9m ²	-	-
BAL FASTFLEX	7.5kg & 5L	-	-	-	2.9m ²	1.9m ²	2.5m ²

The coverages may vary dependent on the nature and flatness of the surface.

GROUT COVERAGE

PRODUCT	SIZE	WALL 150x150x5.5mm 2mm Joint	WALL 200x200x5.5mm 2mm Joint	FLOOR 300x300x9mm 3mm Joint	FLOOR 200x200x9mm 3mm Joint
BAL WALL GROUTS					
BAL MICROFLEX WALL GROUT	10kg	52.6m ²	71.4m ²	-	-
	3.5kg	18.4m ²	25.0m ²	-	-
BAL SUPERFLEX WALL GROUT	10kg	52.6m ²	71.4m ²	-	-
	3.5kg	18.4m ²	25.0m ²	-	-
BAL SUPERCOLOUR WALL GROUT	10kg	43.5m ²	58.8m ²	-	-
	3.5kg	15.2m ²	20.6m ²	-	-
BAL GROUT	20kg	105.3m ²	142.9m ²	-	-
	10kg	52.6m ²	71.4m ²	-	-
	3.5kg	18.4m ²	25.0m ²	-	-
	1.5kg	7.9m ²	10.7m ²	-	-
	0.5kg	2.6m ²	3.6m ²	-	-
BAL SUPERGROUT	4kg	17.4m ²	23.5m ²	-	-
	1.5kg	6.5m ²	8.8m ²	-	-

BAL WIDE JOINT GROUTS

BAL MICROFLEX WIDE JOINT GROUT	10kg	-	-	29.4m ²	19.6m ²
	3.5kg	-	-	10.3m ²	6.9m ²
BAL SUPERFLEX WIDE JOINT GROUT	10kg	-	-	29.4m ²	19.6m ²
	3.5kg	-	-	10.3m ²	6.9m ²
BAL SUPERCOLOUR WIDE JOINT GROUT	10kg	-	-	40.0m ²	26.3m ²
	3.5kg	-	-	14.0m ²	9.2m ²
BAL WIDE JOINT GROUT	10kg	-	-	34.0m ²	22.7m ²
	3.5kg	-	-	12.1m ²	8.0m ²
BAL FLEXGROUT	10kg	-	-	33.3m ²	22.2m ²
	3.5kg	-	-	11.7m ²	7.8m ²

BAL EPOXY GROUTS

BAL MICROPOXY	4kg	16.0m ²	21.1m ²	12.9m ²	8.7m ²
	1kg	4.0m ²	5.3m ²	3.2m ²	2.2m ²
BAL MICROPOXY LV	10kg	-	-	33.3m ²	22.2m ²
BAL EASYPOXY	5kg	20.8m ²	27.8m ²	16.7m ²	11.1m ²
	2kg	8.3m ²	11.1m ²	6.7m ²	4.4m ²
	1kg	4.2m ²	5.6m ²	3.3m ²	2.2m ²
BAL FLOOR EPOXY	10kg	-	-	32.3m ²	21.7m ²
BAL EPOXY LV	10kg	-	-	33.3m ²	22.2m ²

WALL TILE ADHESIVE SELECTOR

	READY MIXED				CEMENTITIOUS	FLEXIBLE CEMENTITIOUS			2 PART
	BAL GREEN STAR	BAL BLUE STAR	BAL WHITE STAR	BAL TILE & GROUT	BAL CTF 3	BAL MOSAIC-FIX	BAL SINGLE PART FLEXIBLE	BAL RAPIDSET FLEXIBLE	BAL FLEX
Interior, Dry	●	●	●	●	●	●	●	●	●
Exterior	-	-	-	-	●	●	●	●	●
INSTALLATION									
Bathroom, Intermittent Wetting	●	●	●	●	●	●	●	●	●
Domestic Shower	-	-	●	-	●	●	●	●	●
Communal Shower	-	-	●	-	●	●	●	●	●
Swimming Pool	-	-	-	-	●	●	●	●	●
Minor Vibration	-	-	●	●	●+A	●	●	●	●
Limited Deflection	-	-	-	-	-	-	-	-	●
BACKGROUNDS									
Cement: Sand Rendering	●	●	●	●	●	●	●	●	●
Standard Brick/Block	-	-	-	-	●+A	●	●	●	●
Dense Brick/Block/Concrete	-	-	-	-	●+A+P	●+P	●+P	●+P	●
Lightweight Blockwork	●	●	●	●	●+P	●+P	●+P	●+P	●
Plaster	●	●	●	●	●+A+P	●+P	●+P	●+P	●
Plasterboard	●	●	●	●	●+A	●	●	●	●
Tile Backer Boards	●	●	●	●	●	●	●	●	●
Fibre Cement Sheets	-	-	●	●	-	●	-	-	●
MDF Board	●	●	●	●	●	●	●	●	●
Unglazed Ceramic Tiles	●	●	●	●	●	●	●	●	●
Hard Natural Stone	●	●	●	●	●	●	●	●	●
Plywood Walls	●	●	●	●	-	-	-	-	●
Painted Walls	●	●	●	●	-	-	-	-	●
Glazed Ceramic Tiles	●	●	●	●	●+A	●	●	●	●
Steel	-	-	-	-	-	-	-	-	●

WALL TILE GROUT SELECTOR

	READY MIXED	CEMENTITIOUS			PRO-HYGIENE SYSTEMS		EPOXY RESIN
	BAL SUPERGROUT	BAL GROUT	BAL SUPERCOLOUR WALL GROUT	BAL SUPERFLEX WALL GROUT	BAL MICROFLEX	BAL MICROPOXY	BAL EASYPOXY
Interior, Dry	●	●	●	●	●	●	●
Exterior	-	●	●	●	●	●	●
INSTALLATION							
Bathroom, Intermittent Wetting	●	●	●	●	●	●	●
Domestic Shower	-	●	●	●	●	●	●
Communal Shower	-	●	●	●	●	●	●
Swimming Pool	-	●	-	●	●	●	●
Worktop	-	-	-	-	-	●	●
SPECIAL REQUIREMENTS							
Antibacterial	-	-	-	-	●	●	-
Hygienic, Sterile Conditions For Food Use	-	-	-	-	-	●	●
Chemical Resistance	-	-	-	-	-	●	●
Minor Vibration	●	●+A	●	●	●	●	●
Limited Deflection	●	●+A	●	●	●	●	●

FLOOR TILE ADHESIVE SELECTOR

	CEMENTITIOUS				FLEXIBLE CEMENTITIOUS				2 PART	
	BAL GOLD STAR	BAL CTF 3	BAL RAPIDSET	BAL POURABLE THICK BED	BAL MOSAIC-FIX	BAL GREEN SCREED ADHESIVE	BAL SINGLE PART FLEXIBLE	BAL RAPIDSET FLEXIBLE	BAL PTB FLEXIBLE	BAL FASTFLEX
Interior, Dry	●	●	●	●	●	●	●	●	●	●
Exterior	●	●	●	●	●	●	●	●	●	●
INSTALLATION										
Bathroom, Intermittent Wetting	●	●	●	●	●	●	●	●	●	●
Domestic Shower	●	●	●	●	●	●	●	●	●	●
Communal Shower	●	●	●	●	●	●	●	●	●	●
Swimming Pool	●	●	●	●	●	●	●	●	●	●
Minor Vibration	●+A	●+A	●+A	●+A	●	●	●	●	●	●
Heavy Trafficking	●+A	●+A	●+A	●+A	●	●	●	●	●	●
Limited Deflection	-	-	-	-	-	-	-	-	-	●
BASES										
Plywood Overlaid Floors	●+A	●+A	●+A	●+A	●	-	●	●	●	●
Suspended Concrete Floor	●+A	●+A	●+A	●+A	●	●	●	●	●	●
Tongue & Groove Floorboards	-	-	-	-	-	-	-	-	-	●
Cement: Sand Screed	●	●	●	●	●	●	●	●	●	●
Mastic Asphalt	●	●	●	●	●	●	●	●	●	●
Anhydrite Screed	●+P	●+P	●+P	●+P	●+P	-	●+P	●+P	●+P	●+P
Heated Screeds	●+A	●+A	●+A	●+A	●	●	●	●	●	●
Vinyl Tiles/Sheets	●+A or B	●+A or B	●+A or B	●+A or B	●	-	●	●	●	●
Unglazed Ceramic Tiles	●	●	●	●	●	-	●	●	●	●
Hard Natural Stone	●	●	●	●	●	-	●	●	●	●
Glazed Ceramic Tiles	●+A	●+A	●+A	●+A	●	-	-	-	-	●
Steel	-	-	-	-	-	-	-	-	-	●
Epoxy Paint	●+A	●+A	●+A	●+A	● 1	-	● 1	● 1	● 1	●

FLOOR TILE GROUT SELECTOR

	CEMENTITIOUS			PRO-HYGIENE SYSTEMS			EPOXY RESIN		
	BAL WIDE JOINT GROUT	BAL SUPERCOLOUR WIDE JOINT	BAL SUPERFLEX WIDE JOINT	BAL MICROFLEX WIDE JOINT	BAL MICROPOXY	BAL MICROPOXY LV	BAL EASYPOLY	BAL FLOOR EPOXY	BAL EPOXY LV
Interior	●	●	●	●	●	●	●	●	●
Exterior	●	●	●	●	●	●	●	●	●
INSTALLATION									
Bathroom, Intermittent Wetting	●	●	●	●	●	●	●	●	●
Domestic Shower	●	●	●	●	●	-	●	●	-
Communal Shower	●	●	●	●	●	●	●	●	●
Swimming Pool	●	-	●	●	●	●	●	●	●
Floating Wooden Floors	●+A	-	-	-	●	●	●	●	●
SPECIAL REQUIREMENTS									
Antibacterial	-	-	-	●	●	●	-	-	-
Hygienic, Sterile Conditions For Food Use	-	-	-	-	●	●	●	●	●
Chemical Resistance	-	-	-	-	●	●	●	●	●
Minor Vibration	●+A	●	●	●	●	●	●	●	●
Limited Deflection	●+A	●	●	●	●	●	●	●	●
Moderate Trafficking	●	●	●	-	●	●	●	●	●
Heavy Trafficking	●+A	●	●	-	-	●	-	●	●

TILE CALCULATOR

Tile size in inches & cm	Area to be tiled in m ²														
	1	2	3	4	5	6	7	8	9	10	20	25	30		
4 x 4" 10 x 10	100	200	300	400	500	600	700	800	900	1000	2000	2500	3000		
4 1/4 x 4 1/4" 10.8 x 10.8	86	172	258	344	430	516	602	688	774	860	1720	2150	2580		
8 x 4" 20 x 10	50	100	150	200	250	300	350	400	450	500	1000	1250	1500		
6 x 6" 15 x 15	44	88	132	176	220	264	308	352	396	440	880	1100	1320		
8 x 6" 20 x 15	33	66	99	132	165	198	231	264	297	330	660	825	990		
8 x 8" 20 x 20	25	50	75	100	125	150	175	200	225	250	500	625	750		
10 x 8" 25 x 20	20	40	60	80	100	120	140	160	180	200	400	500	600		
8 x 12" 20 x 30	17	34	51	68	85	102	119	136	153	170	340	425	510		
10 x 14 1/8" 25 x 36.5	11	22	33	44	55	66	77	88	99	110	220	275	330		
12 x 10" 30 x 25	13	26	39	52	65	78	91	104	117	130	260	325	390		
12 x 12" 30 x 30	11	22	33	44	55	66	77	88	99	110	220	275	330		
12 1/4 x 12 1/4" 31.2 x 31.2	10	20	30	40	50	60	70	80	90	100	200	250	300		
13 x 13" 33 x 33	9	18	27	36	45	54	63	72	81	90	180	225	270		
12 1/4 x 8 1/4" 31 x 21 (Octagon incl. taco)	15	30	45	60	75	90	105	120	135	150	300	375	450		

FLEXIBILITY CHART

ADHESIVES

	+	BAL Flex BAL Fastflex
		BAL Gold Star + BAL Admix AD1 BAL CTF 3 + BAL Admix AD1 BAL Rapidset + BAL Admix AD1 BAL Pourable Thick Bed + BAL Admix AD1
		BAL Mosaic-Fix BAL Green Screed Adhesive BAL Single Part Flexible BAL Rapidset Flexible BAL PTB Flexible
		BAL Gold Star BAL CTF 3 BAL Rapidset BAL Pourable Thick Bed
	-	

GROUTS

	+	BAL Grout + BAL Admix GT1 BAL Wide Joint Grout + BAL Admix GT1 BAL Grout Flooring + BAL Admix GT1
		BAL SupergROUT BAL Microflex Wall Grout BAL Superflex Wall Grout BAL Microflex Wide Joint Grout BAL Superflex Wide Joint Grout
		BAL Supercolor Wall Grout BAL Supercolor Wide Joint Grout BAL Flexgrout
		BAL Grout BAL Wide Joint Grout BAL Grout Flooring
	-	

PREPARATION PRODUCTS

BAL MULTIBASE



Floor levelling compound, suitable for use on most bases in interior locations. Single part system: 25kg bags.

- Interior
- Self-smoothing
- Rapid-setting

BAL ACRYBASE



Floor levelling compound for use on most bases in interior and exterior locations. 2 part system: 23.5kg bag & 5L bottle.

- Interior/exterior
- Self-smoothing
- Rapid-setting

BAL WP1 TANKING SYSTEM/Shower KIT



A waterproofing system for most walls and floors prior to the application of ceramic tiles in interior locations such as showers, bathrooms & toilets. Suitable for use with underfloor heating, not suitable for swimming pools.

- Seamless
- Waterproof
- Interior use

BAL QUICKSET CEMENT



Specially formulated for the preparation of rapid hardening, low shrinkage mortars to be used as screeds or renders in interior, exterior or underwater locations. Screed may be walked on after 3 hours and tiled after 24 hours. Available in 25kg bags.

- Walls/floors
- Fast-setting
- Water/frost resistant

BAL PRIME APD



A rapid-drying primer suitable for use prior to tile fixing to a number of backgrounds and prior to the application of a levelling compound. It provides surface strength and helps to reduce the porosity of the background. Available in 2.5L bottles.

- Blue
- Walls/floors
- Interior/exterior

BAL BOND SBR



A water-based polymer that may be used for many applications in the construction industry: as a slurry coat, admixture, primer, sealer or dust proofer. Available in 5L & 1L bottles.

- Water/frost resistant
- Interior/exterior
- White

WALL TILING

BAL BLUE STAR



A white ready mixed ceramic wall tile adhesive designed for use in internal dry and intermittently wet areas. It can be used in domestic showers. Available in 15kg, 7.5kg, 3.75kg & 1.5kg buckets. BS EN 12004 D1T Adhesive.

- Non-slip
- High bond strength

BAL GREEN STAR



A ready mixed ceramic wall tile adhesive designed for use in internal dry and intermittently wet areas. It can be used in domestic showers. Available in 15kg, 7.5kg & 3.75kg buckets. BS EN 12004 D1T Adhesive.

- Non-slip
- Extended open time
- High bond strength

BAL WHITE STAR



A white ready mixed ceramic wall tile adhesive designed for use in internal wet and dry areas. Suitable for use in domestic or commercial applications such as communal showers. Available in 10L, 5L, 2.5L & 1L buckets. BS EN 12004 D2TE Adhesive.

- Highly flexible
- Non-slip
- Water-resistant
- High bond strength

BAL GRIP



A white, flexible, water-resistant, non slip ready-mixed ceramic wall tile adhesive designed for use in internal wet and dry areas. Available in 15kg & 7.5kg buckets. BS EN 12004 D2T Adhesive.

- Flexible
- Non-slip
- Water-resistant

BAL TILE & GROUT



A brilliant white ready mixed ceramic wall tile adhesive and grout. Use on interior walls including bathrooms, showers and kitchens. Available in 15kg, 7.5kg, 3.75kg & 1.5kg buckets. BS EN 12004 D2T Adhesive.

- Waterproof
- Mould-resistant
- Non-slip
- Fix & grout

BAL GLASS BLOCK ADHESIVE MORTAR



A white mortar to be used in the construction of glass block walls. Especially suitable for domestic and communal showers. Available in 25kg bags.

- Easy to use
- Interior/exterior
- Water/frost-resistant

BAL FLEX



A grey 2 part adhesive suitable for wall and floor tiling applications. Suitable for fixing ceramic wall tiles, mosaics and dark natural stone, including fully vitrified and porcelain tiles, to most backgrounds. Powder available in 7kg bags, liquid in 5L & 20L bottles. BS EN 12004 C1TS2 Adhesive.

- Highly flexible
- Interior/exterior
- Non-slip

WALL & FLOOR TILE ADHESIVES

BAL MOSAIC-FIX

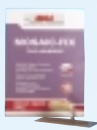

A bright white, water and frost-resistant cementitious wall and floor tile adhesive specially formulated for fixing mosaic tiles including glass mosaics. Suitable for use in swimming pools. Available in 20kg, 10kg & 5kg bags. BS EN12004 C2TS1 Adhesive.

- Suitable for most surfaces including MDF in internal dry areas
- Non-slip
- Interior/exterior

BAL RAPIDSET FLEXIBLE



A rapid setting, flexible cementitious tile adhesive suitable for wall and floor applications. Suitable for fixing fully vitrified and porcelain tiles to most backgrounds. Available in grey & white, in 20kg & 10kg (grey only) bags. BS EN12004 C2FS1 Adhesive.

- Rapid-setting
- Non-slip
- Flexible
- Interior/exterior

BAL SINGLE PART FLEXIBLE



A flexible cementitious tile adhesive suitable for wall and floor applications. Suitable for fixing fully vitrified and porcelain tiles to most backgrounds. Available in grey & white in 20kg & 10kg (white only) bags. BS EN 12004 C2T Adhesive.

- Flexible
- Interior/exterior
- Non-slip

BAL RAPIDSET



A rapid-setting, water and frost-resistant cementitious tile adhesive for wall and floor applications. Suitable for fixing fully vitrified and porcelain tiles to most backgrounds/bases. The product properties can be improved with the addition of BAL Admix AD1. Available in 22.5kg, 20kg, 10kg & 5kg bags. BS EN12004 C2FT Adhesive.

- Rapid-setting
- Interior/exterior
- Non-slip
- Grey & White

BAL GOLD STAR



A grey cementitious tile adhesive for wall and floor applications. Suitable for fixing fully vitrified and porcelain tiles to most backgrounds/bases. Extended working time. The product properties can be improved with the addition of BAL Admix AD1. Available in 20kg, 10kg & 5kg bags. BS EN 12004 C2T Adhesive.

- Non-slip
- Interior/exterior
- Water/frost resistant

BAL CTF 3



A white cementitious tile adhesive for wall and floor applications. Extended working time. The product properties can be improved with the addition of BAL Admix AD1. Available in 20kg & 10kg bags. BS EN 12004 C1T Adhesive.

- Non-slip
- Interior/exterior
- Water/frost resistant

FLOOR TILE ADHESIVES

BAL FASTFLEX



A highly flexible, rapid-setting, 2 part adhesive suitable for floor tiling applications. Suitable for fixing fully vitrified and porcelain tiles to most bases. Ideal for fixing directly onto wooden floorboards. Powder available in Grey & White, in 7.5kg bags, liquid in 5L bottles. BS EN 12004 C1FS2 Adhesive.

- Rapid-setting
- Non-slip
- Highly flexible
- Interior/exterior

BAL GREEN SCREED ADHESIVE



A grey, highly flexible, water and frost-resistant tile adhesive for floor tiling applications. Suitable for fixing fully vitrified and porcelain tiles. Ideal for fast track installation on newly laid screeds or concrete. Available in 20kg bags. BS EN 12004 C1ES1 Adhesive.

- 7 days cure time for new concrete and 24 hours for new screeds
- Accommodates background shrinkage
- Interior/exterior use

BAL PTB FLEXIBLE



A flexible, rapid-setting, pourable thick bed adhesive suitable for fixing large format floor tiles and floor tiles with profiled backs without the need to back-butter. Suitable for fixing fully vitrified and porcelain tiles to most bases. Available in Grey & White, in 20kg bags. BS EN 12004 C2F Adhesive.

- Rapid-setting
- Interior/exterior
- Flexible

BAL POURABLE THICK BED



A grey, rapid-setting, pourable thick bed adhesive suitable for fixing large format floor tiles and floor tiles with profiled backs without the need to back-butter. The product properties can be improved with the addition of BAL Admix AD1. Available in 20kg bags. BS EN 12004 C1F Adhesive.

- Rapid-setting
- Interior/exterior
- Water/frost resistant

BAL MOTOBOND



Specially designed for use in motor showrooms, formulated to withstand heavy loading and trafficking. Suitable for use with large format tiles onto most standard bases. Available in grey, packed in 25kg bags. BS EN 12004 C2F Adhesive.

- Rapid-setting
- Interior/exterior
- High bond strength

BAL ADMIX AD1



Use with BAL Rapidset, Goldstar, CTF 3 and Pourable Thick Bed adhesives to improve their physical properties and performance. Available in 3.5L & 2.5L bottles.

- Improves adhesion
- Reduces water permeability
- Imparts durability

NARROW JOINT GROUTS

BAL SUPERGROUT



A ready mixed, waterproof ceramic wall tile grout for use in showers, bathrooms and kitchens. Available in white & ivory, packed in 5kg (white only) and 1.5kg buckets.

- Waterproof
- Interior use
- Suitable for glazed wall tiles and mosaics

BAL SUPERFLEX WALL GROUT



A brilliant white, water and frost-resistant cementitious wall tile grout with built-in admixture to give increased flexibility and high bond strength. Suitable for grouting porcelain, marble, natural stone, glass and ceramic mosaics, glazed and fully vitrified tiles. Available in white, packed in 10kg & 3.5kg bags. BS EN 13888 CG2 Grout.

- Built-in flexibility
- High bond strength
- Interior/exterior use
- Suitable for power showers and swimming pools

BAL GROUT

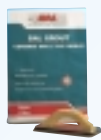

A fine, cementitious wall tile grout designed for grouting glazed wall tiles and mosaics. The product properties can be enhanced by the addition of BAL ADMIX GT1. Available in white, ivory and grey. Packed in 20kg, 10kg, 3.5kg, 1.5kg & 0.5kg bags. BS EN 13888 CG1 Grout.

- Water/frost-resistant
- Interior use
- Suitable for swimming pools

BAL EASYPOXY



A waterproof 2 part epoxy grout formulated to resist chemical attack and to provide a durable, abrasion-resistant finish. Also suitable as a high performance epoxy adhesive for fixing ceramic tiles, on walls, floors, and worktops. Available in white, ivory & grey. Packed in 5kg, 2kg & 1kg buckets. BS EN 13888 RG1 Grout.

- Waterproof
- Hygienic
- Easy to use

BAL GROUT FLOORING



A grey, cementitious flooring grout for ceramic tiles and quarry tiles. Available in 25kg, 12.5kg & 3.5kg bags. BS EN 13888 CG1 Grout.

- Interior/exterior use
- Water/frost-resistant

NARROW JOINT GROUTS

BAL SUPERCOLOR WALL GROUT



A fast-setting, efflorescence-free, water and frost-resistant cementitious grout for ceramic tiles, porcelain, marble, natural stone, glass and fully vitrified tiles. Suitable for grouting wall tiles with joint widths up to 7mm in interior and exterior locations including power showers. Available in 24 colours, packed in 10kg & 3.5kg bags. BS EN 13888 CG2F Grout.

- Sets in 5 hours
- Efflorescence-free
- 24 colours available

BAL MICROFLEX WALL GROUT



A white cementitious wall tile grout with built-in Microban® antibacterial protection to inhibit the growth of bacteria and black mould. Ideal for bathrooms, showers and food consumption areas. Available in white, packed in 10kg & 3.5kg bags. BS EN 13888 CG2 Grout.

- Continuous protection against bacteria and black mould
- Stain resistant
- Built-in flexibility

BAL MICROPOXY EPOXY GROUT



A 2 part epoxy grout with continuous built-in Microban® antibacterial protection to inhibit the growth of bacteria and black mould. Also suitable as a high performance epoxy adhesive for fixing ceramic tiles. Available in white & grey, in 4kg & 1kg buckets. BS EN 13888 RG1 Grout.

- Waterproof
- Continuous protection against bacteria and black mould
- Chemical resistant
- Does not taint food

BAL ADMIX GT1



Use with BAL cementitious grouts to improve their physical properties and characteristics. Available in 2.5L & 1.5L bottles.

- Increased mechanical strength
- Increased flexural strength and flexibility
- Reduced water permeability
- Increased durability

BAL PROTECTIVE SEALER



A water-based sealer formulated to provide a temporary, protective coating to ceramic tile/mosaic surfaces during the grouting process. Suitable for use with all BAL grouting products. Available in 2.5L bottles.

- Protects tiles during grouting
- Protects against grout staining
- Cleans off after grouting

WIDE JOINT GROUTS

BAL SUPERFLEX WIDE JOINT GROUT



A highly flexible cementitious powder grout with built-in admixture to give increased flexibility and high bond strength. Suitable for grouting fully vitrified/porcelain tiles. Ideal for grouting limited movement areas such as timber floors or heated screeds. Available in grey, sandstone & limestone. Packed in 10kg & 3.5kg bags. BS EN 13888 CG2 Grout.

- Flexible
- Floors/walls
- Interior/exterior use
- Suitable for swimming pools

BAL WIDE JOINT GROUT

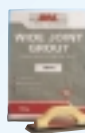

A cementitious grout designed for grouting ceramic floor tiles, ceramic mosaics and quarries. Available in white, ivory, grey, dark brown, charcoal & sandstone. Packed in 10kg & 3.5kg bags. BS EN 13888 CG1 Grout.

- Water/frost-resistant
- Interior/exterior use
- Suitable for wet and dry conditions
- Floors/walls
- Suitable for swimming pools

BAL FLEXGROUT

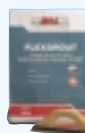

A grey flexible cementitious grout for use in areas where limited movement or vibration is expected. Suitable for grouting ceramic tiles, mosaics and quarries. Available in 10kg & 3.5kg bags. BS EN 13888 CG1 Grout.

- Flexible
- Floors/walls
- Interior/exterior use
- Suitable for swimming pools

BAL SUPERCOLOUR WIDE JOINT GROUT



A fast-setting, efflorescence-free, water and frost-resistant cementitious grout for ceramic tiles, porcelain, marble, natural stone, glass and fully vitrified tiles. Suitable for grouting tiles with joint widths up to 20mm in interior and exterior locations. Available in 24 colours, packed in 10kg & 3.5kg bags. BS EN 13888 CG2F Grout.

- Sets in 5 hours
- Efflorescence-free
- 24 colours available

BAL MOTOGROUT



A grey, durable, water/frost resistant cementitious grout designed for use in motor showrooms. Formulated to withstand heavy loading and trafficking. Available in 12.5kg bags. BS EN 13888 CG2 Grout.

- Ideal for heavily trafficked floors
- High adhesion strength

WIDE JOINT GROUTS

BAL FLOOR EPOXY



A waterproof 3 part epoxy floor tile grout formulated to resist chemical attack, abrasion and impact. Also suitable as a high performance epoxy adhesive for fixing ceramic tiles on walls, floors, and worktops. Available in grey & ivory. Packed in 10kg buckets (2x5kg units). BS EN 13888 RG1 Grout.

- Waterproof
- Hygienic
- Hard wearing

BAL EPOXY LV



A grey, high quality, flowable, 3 part epoxy grout formulated to provide hygienic, chemically resistant, watertight joints between ceramic floor tiles. Ideal for large installations where its ease of use, speed of application and clean-off provide significant time savings. Also suitable as a high performance epoxy adhesive for fixing ceramic tiles. Available in 10kg buckets.

BS EN 13888 RG1 Grout.

- Flowable
- Hygienic
- Waterproof
- Ideal for large installations

BAL MICROFLEX WIDE JOINT GROUT

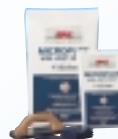

A grey cementitious grout with built-in Microban® antibacterial protection to inhibit the growth of bacteria and black mould. Ideal for bathrooms, showers and food consumption areas. Available in 10kg & 3.5kg bags. BS EN 13888 CG2 Grout.

- Continuous protection against bacteria and black mould
- Stain resistant
- Built-in flexibility

BAL MICROPOXY LV FLOWABLE EPOXY GROUT



A grey, 3 part epoxy resin based grout with continuous built-in Microban® antibacterial protection to inhibit the growth of bacteria and black mould. Ideal for large installations where its ease of use, speed of application and clean-off provide significant time savings. Available in 10kg buckets. BS EN 13888 RG1 Grout.

- Flowable
- Continuous protection against bacteria and black mould
- Waterproof
- Ideal for large installations

SEALANTS & AFTERCARE

BAL MICROSEAL SILICONE SEALANT



A high-performance silicone sealant with Microban® antibacterial protection. Ideal for use in hygiene critical areas, sterile units, bathrooms and showers. Available in white & grey, in 310ml cartridges.

- Continuous built-in protection against bacteria and black mould
- Waterproof
- Does not taint food

BAL SILICONE SEALANT



A silicone sealant for use in movement joints and as a general sealant within domestic/light commercial wall and floor tiling applications. Bonds to glass, ceramic, porcelain and acrylic/fibreglass. Available in white, cream & transparent, in 310ml cartridges.

- Waterproof
- Flexible

BAL MICROREVIVE



A white wall grout reviver with Microban® antibacterial protection. It renews the appearance of existing grout. Interior use. Available in 500g pots.

- Continuous built-in protection against bacteria and black mould
- Water/stain-resistant
- Easy to apply

BAL MICROSHIELD WALL TILE CLEANER



A fast-acting tile cleaner with Microban® antibacterial protection to inhibit the growth of bacteria and black mould. Available in 750ml spray bottles.

- Continuous built-in protection against bacteria and black mould
- Removes dirt, grease and stains
- Non-smear, fast acting formula

BAL MICROSHIELD FLOOR TILE CLEANER



A concentrated floor tile cleaner with Microban® antibacterial performance to inhibit the growth of bacteria and black mould. Available in 5L bottles.

- Continuous built-in protection against bacteria and black mould
- Removes dirt, grease and stains
- Non-smear, fast acting formula

AFTERCARE

BAL HEAVY DUTY TILE CLEANER



A powerful, acid based gel cleaner for ceramic tiled floors and walls. Designed for the removal of cement film residues, efflorescence and limescale. Available in 5L & 1L bottles.

- Fast-acting
- Removes limescale
- Easy to apply

BAL IMPREGNATING TILE SEALER



A deep penetrating sealer for use on porous tiles such as terracotta to reduce water permeability of the surface. Available in 1L bottles.

- Water resistant
- Enhances colour
- Prevents staining
- Matt finish

BAL WAX & POLISH REMOVER



A concentrated alkaline cleaner for the removal of old polish, wax residues, dirt, oils and grease from tiled floor surfaces. Available in 1L bottles.

- Stain remover
- Fast-acting
- Dissolves grease

BAL FLOOR TILE POLISH



A tile polish which enriches the appearance of floor finishes by leaving a matt, satin polish. For occasional use. Available in 1L bottles.

- Matt, satin finish
- Protects tiles
- Stain resistant
- Enhances colour

BAL FLOOR TILE CLEAN & WAX



A concentrated cleaner that cleans and protects tiled surfaces by leaving a dirt repellent surface. Available in 1L bottles.

- Cleans and protects
- Repels dirt
- Enhances colour
- Rejuvenates polished tiles

BAL EPOXY GROUT REMOVER



A powerful, solvent based formula for the quick and effective removal of cured epoxy residues from tiles. Available in 1L metal tins.

- Removes cured grout
- Quick and effective
- Easy to apply

BAL SUPERCLOUR WALL & WIDE JOINT GROUTS

All colours shown are available in Supercolour wall & wide joint grouts. Every care has been taken to ensure true colour representation though printing limitations can cause colour variation.

For an actual colour match ask to see a BAL Supercolour Grout selector board.

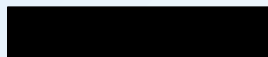

BLACK



VIOLET



BRILLIANT WHITE



DARK BLUE



RED

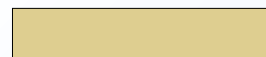

SANDSTONE

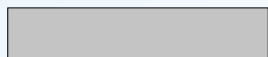

QUARTZ



BLUE



BROWN

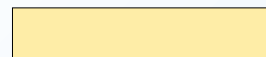

SAND



STEEL GREY



SKY BLUE



RUSSET

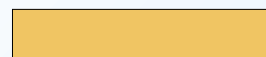

BUFF



SLATE



EVERGREEN



BRICK

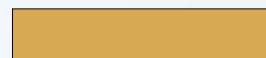

BEIGE

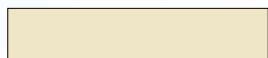

SOFT CREAM



SAGE



TERRACOTTA



LIMESTONE

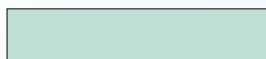

MINT



PINK